

SIZE IN MILLIMETERS

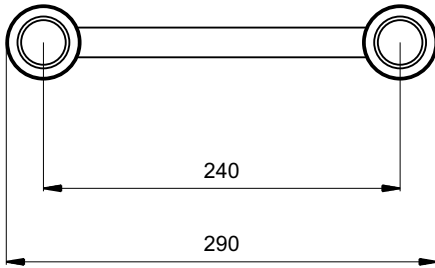

SIZE IN INCHES

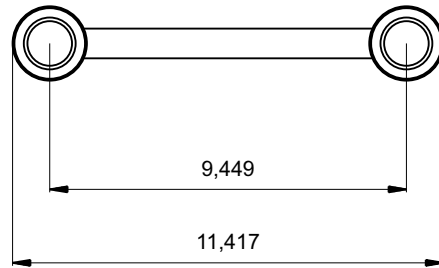

SPECIFICATIONS HT32

TUBES	50x3mm (2 x 0.12inch)
BRACES	20x2mm (0.8 x 0.08inch)
ALLOY	EN-AW 6082 T6



STRAIGHT SEGMENT LENGTHS HT32

CODE	LENGTH		WEIGHT	
HT32-50	0.5m	1.64ft	1.9kg	4.26lbs
HT32-75	0.75m	2.46ft	2.6kg	5.76lbs
HT32-100	1m	3.28ft	3.3kg	7.23lbs
HT32-150	1.5m	4.92ft	4.7kg	10.30lbs
HT32-200	2m	6.56ft	6.1kg	13.34lbs
HT32-250	2.5m	8.20ft	7.4kg	16.38lbs
HT32-300	3m	9.84ft	8.8kg	19.45lbs
HT32-350	3.5m	11.48ft	10.2kg	22.47lbs
HT32-400	4m	13.12ft	11.6kg	25.56lbs
HT32-450	4.5m	14.76ft	13.0kg	28.67lbs
HT32-500	5m	16.40ft	14.4kg	31.64lbs

LOADING TABLES HT32

	2m	4m	6m	8m	10m	12m
Distrib. Load [kg/m]	710	254	115	64	40	27
Deflection [mm]	1.7	9.6	22.3	40.4	64.2	94.1
Point load [kg]	1027	508	344	256	202	165
Deflection [mm]	1.9	7.7	18	32.8	52.5	77.5
	6.56ft	13.12ft	19.68ft	26.24ft	32.81ft	37.37ft
Distrib. Load [lb/ft]	477.2	170.7	77.3	43	26.9	18.1
Deflection [inch]	0.1	0.4	0.9	1.6	2.5	3.7
Point load [lb]	2264.5	1120.1	758.5	564.5	445.4	363.8
Deflection [inch]	0.1	0.3	0.7	1.3	2.1	3.1

The listed loads are verified for simply supported beam. The truss needs to be secured against horizontal movement every 1m for the loading tables to be valid.